



## DRIVER INSTALLATION INSTRUCTIONS

RAZER BLADE STEALTH 13 (2019) INTEL UHD GRAPHICS 620 DRIVER  
VERSION 24.20.100.6294

---

## DRIVER INSTALLATION INSTRUCTIONS

### APPLICABLE MODEL NUMBERS

- RZ09-02812
- RZ09-02810

### DRIVER NAME AND VERSION

Intel UHD Graphics 620 Driver version 24.20.100.6294

### INSTRUCTIONS

**Note:** This download is for the original driver that was installed on your Razer Blade Laptop. Updates for this driver are available via standard Windows Updates. To ensure you have the latest driver installed on your Blade please make sure to apply all available updates from Windows.

Please follow the instructions below to download and install the original driver for your Blade. Following the installation, it is recommended to search for any available Windows Updates.

- Ensure your Blade is plugged into a wall outlet and not running on battery alone before proceeding.
- Please save any open documents on your computer and close all other programs before attempting this update
- Download the driver from the link below. You will need to right click the .zip folder and choose to extract the files to a location of your choosing (such as your desktop) to locate the files for the installation process.

<http://rZR.to/OJysB>

- Once you have extracted the file proceed to the installation steps below.

---

## INSTALLATION PROCESS

1. To initiate the installation, click on the SetupChipset.exe (Application) as shown in the image below:

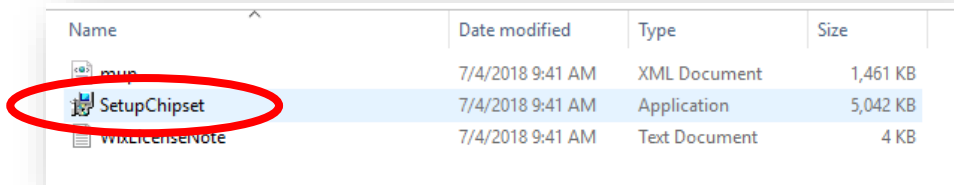

2. You will be presented with the Intel® Chipset Device Software dialogue box upon clicking the SetupChipset.exe (Application) as shown in the previous image. Click 'Next' to begin and follow the on-screen prompts as necessary such as the image below:

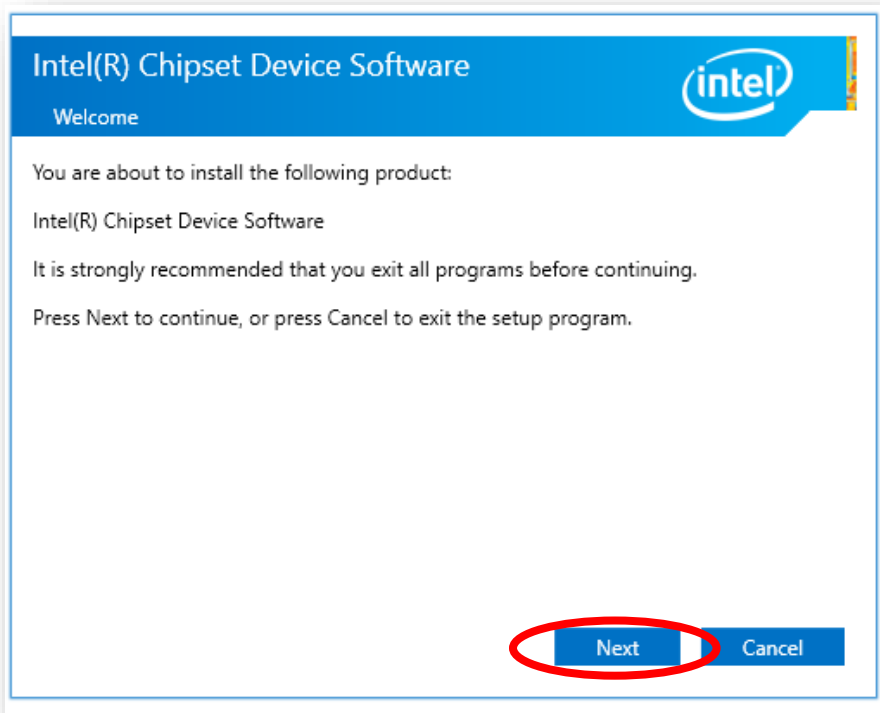

**Note:** Click through the prompts as such: Next > Accept > Install

3. After clicking 'Install', you will be met with the User Account Control window. Click 'Yes' to confirm the changes to be made to your system. Once confirmed, a progress bar for the Intel® Chipset Device Software will appear. Upon completion of the installation, a Restart will be required. You may postpone the restart if needed.

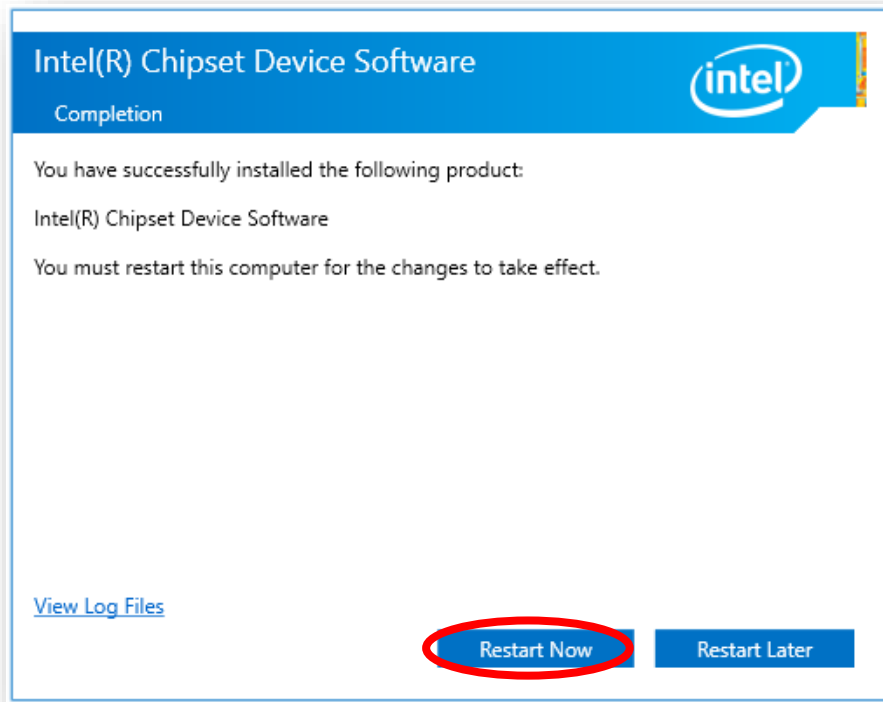

4. End